

MONTAGEANVISNING

SENSUS

MOTOR

LED

SOLCELL



HAROL

WE BELIEVE IN NATURAL COOLING

SENSUS

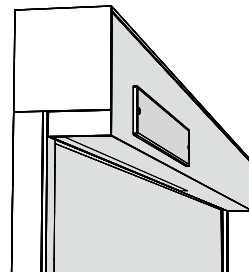
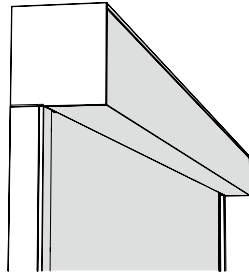
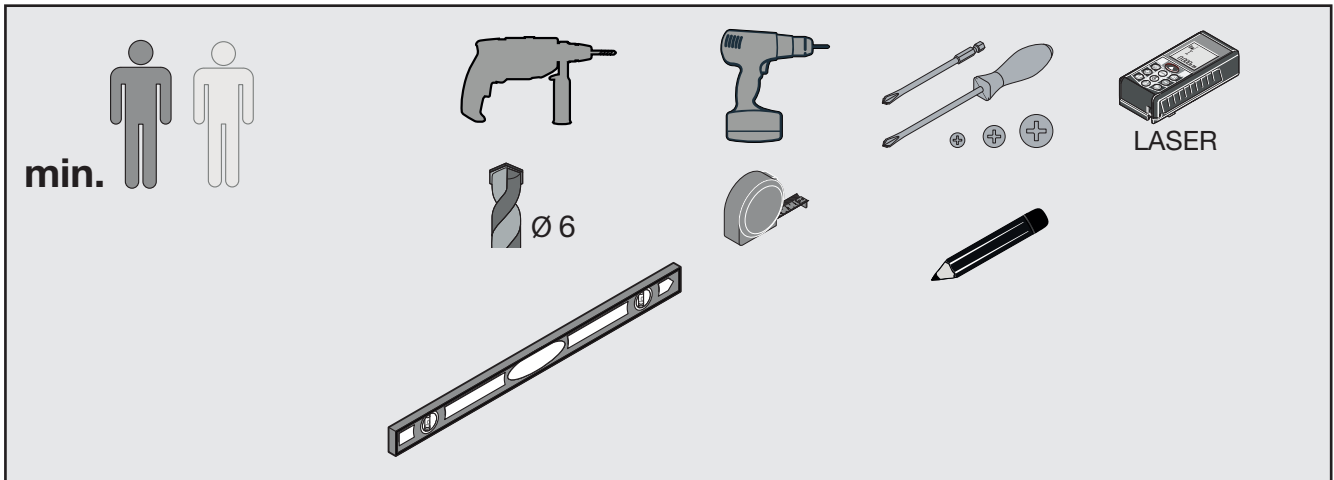

SOLDRIVEN

MOTOR

LED

SOLCELL 



SENSUS MODELLER



MÅTTINSTRUKTION

BREDD

B

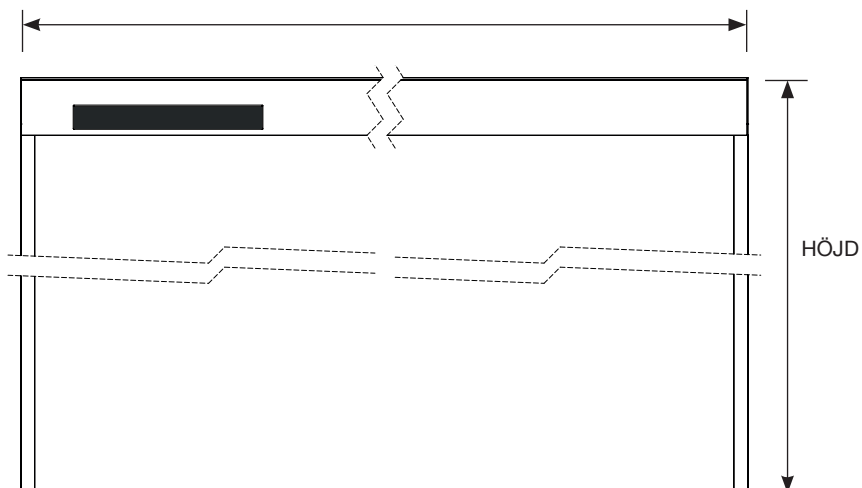



MONTERINGSALTERNATIV

MOTOR LED SOLCELL

VÄGGMONTERING

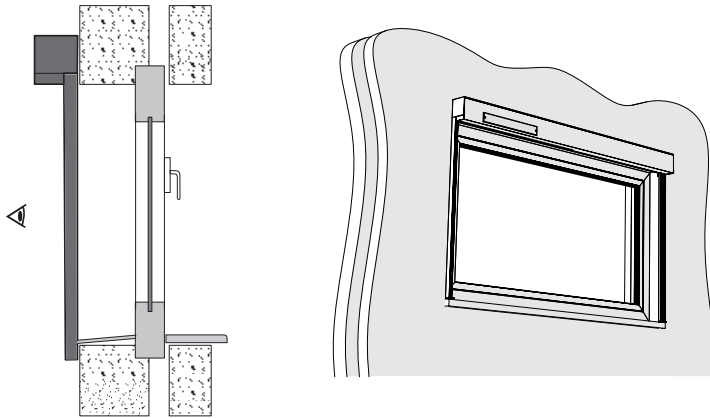

NISCHMONTERING

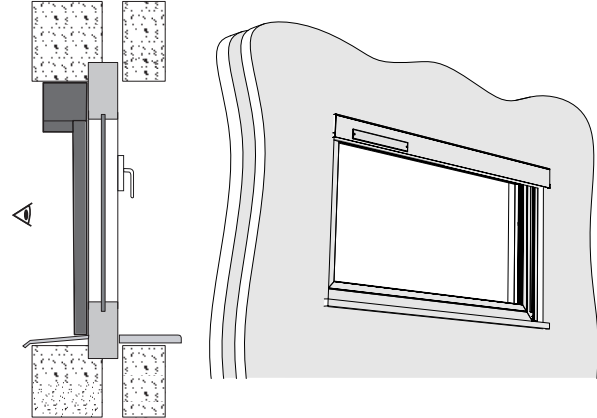

OBS! utrymme som behövs för att öppna kassetten (mm).

MOTOR	 kassett 90 167	 kassett 110 204	 kassett 135 251
LED	 kassett 90 191	 kassett 110 229	 kassett 135 275
SOLCELL	 kassett 90 191	 kassett 110 229	 kassett 135 275



OBS! Vid användning av väggkonsol, glöm ej att räkna med extra 10 mm (A) på höjden för att kunna haka i kassetlocket (B)

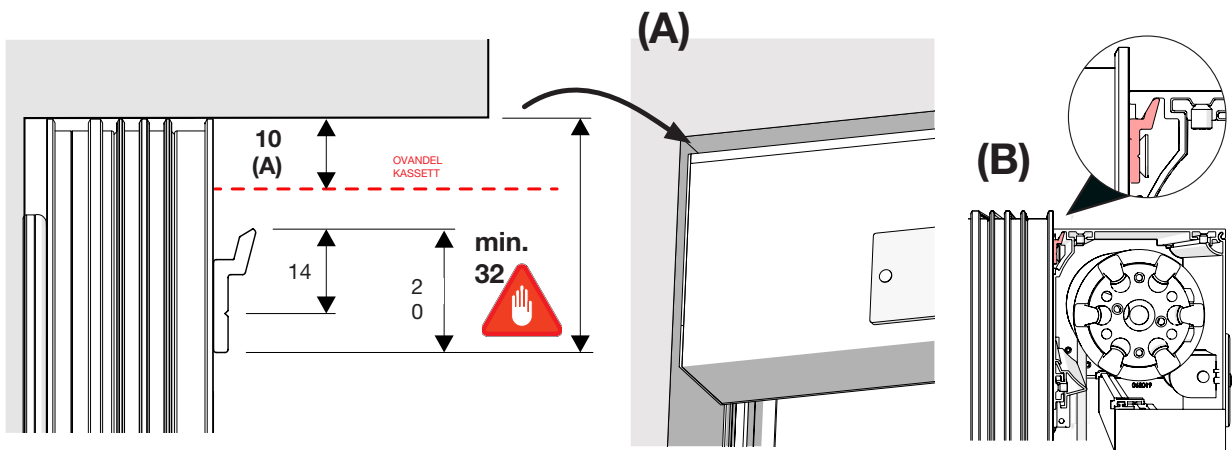

VÄGGMONTERING

1

MOTOR

LED

SOLCELL 

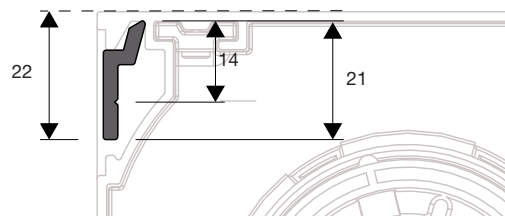
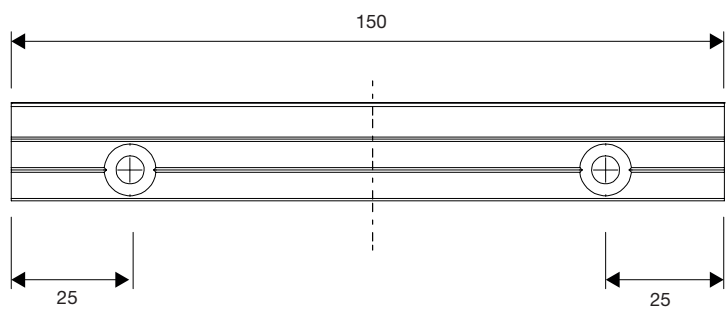
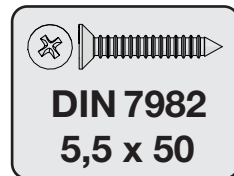
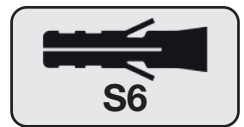
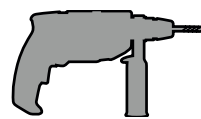
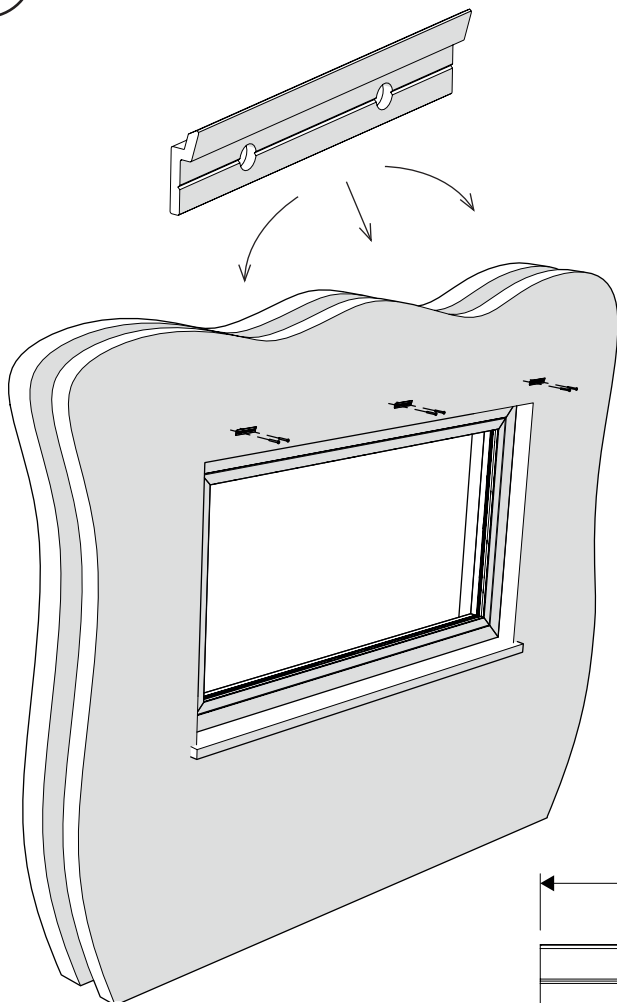

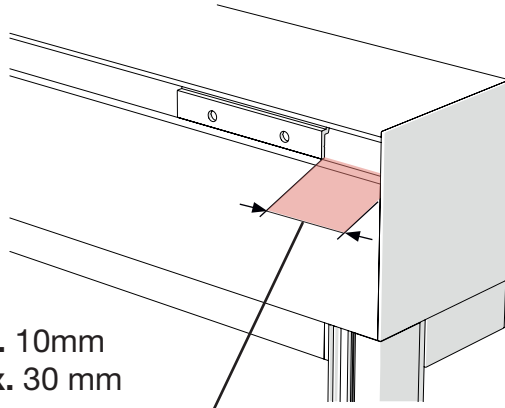
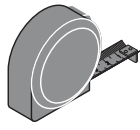

*
min. 10mm
max. 30mm

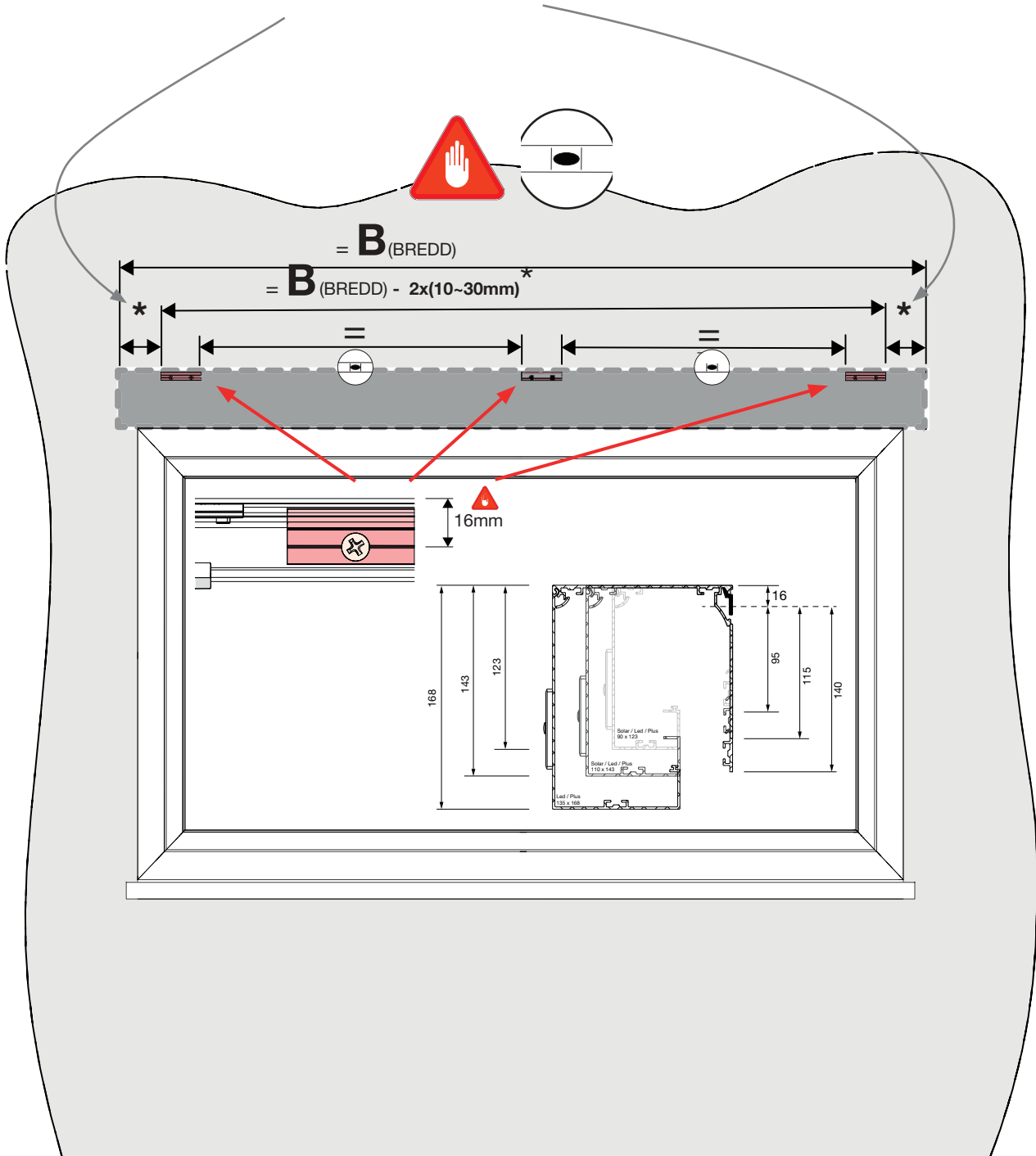

2

MOTOR LED SOLCELL 

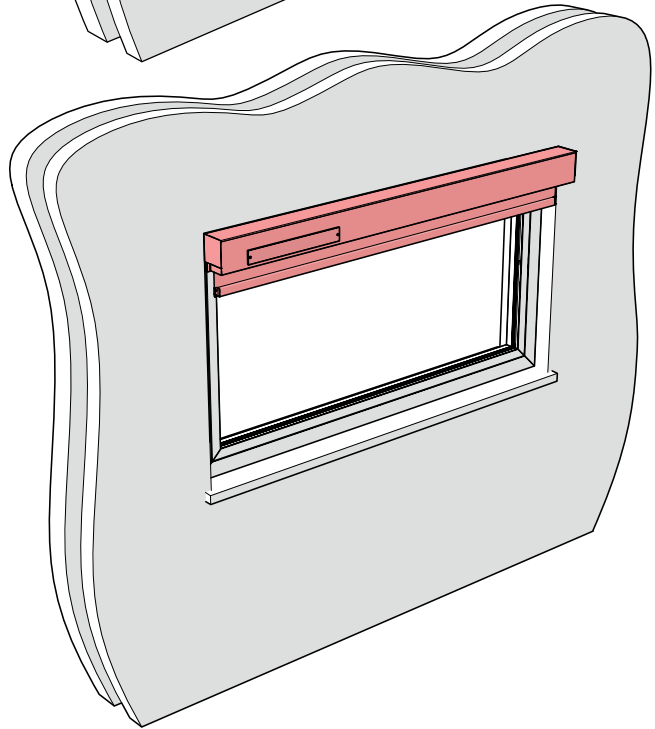
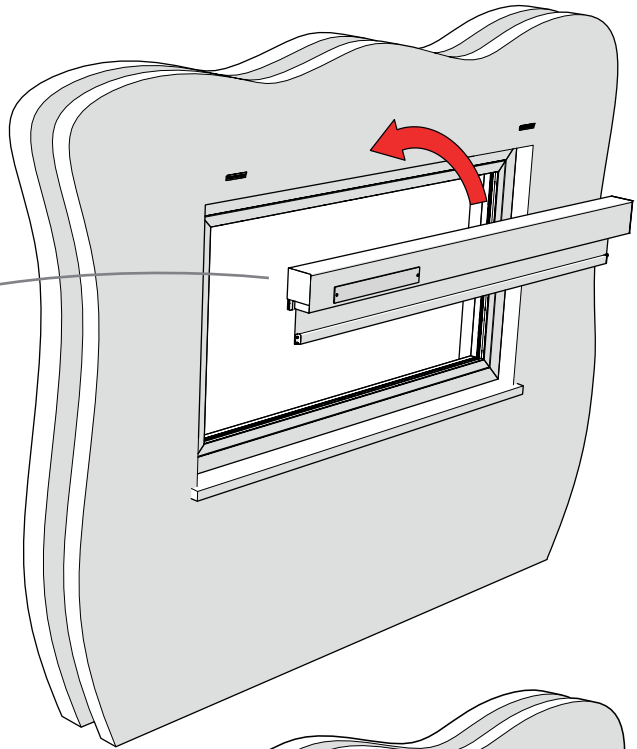
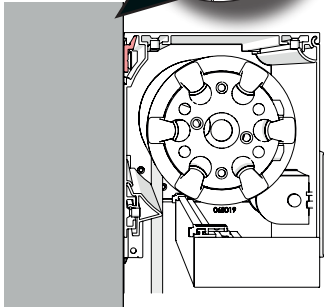
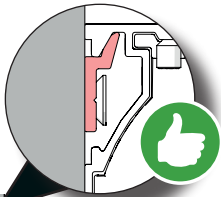
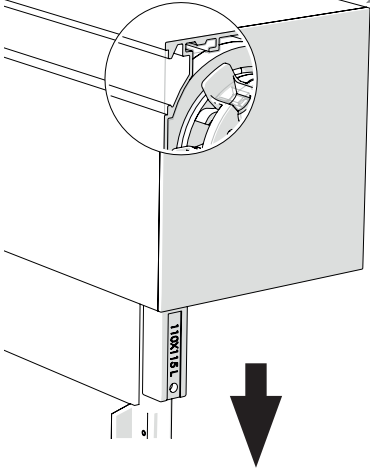
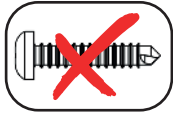



3

MOTOR

LED

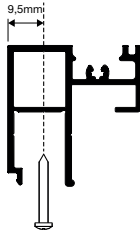
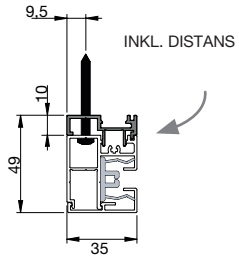
SOLCELL 



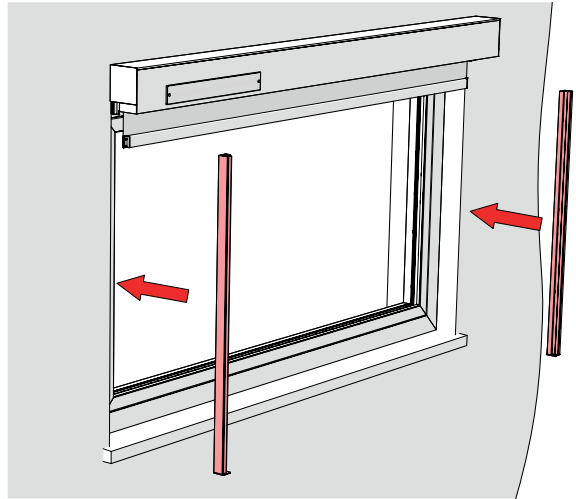

OBS!
Olika längder på skruvarna behövs.



MOTOR

LED

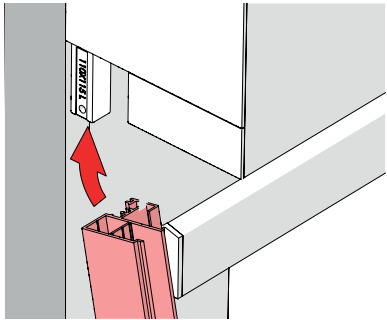
SOLCELL 



MOTOR

LED

SOLCELL 

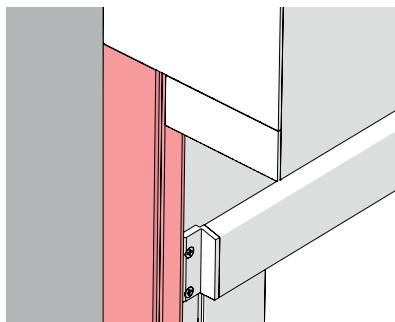
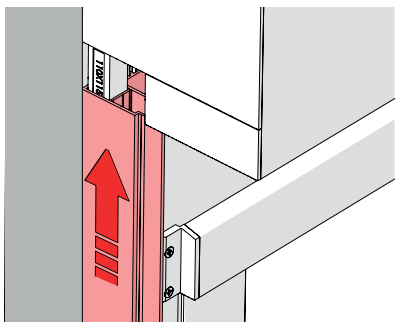

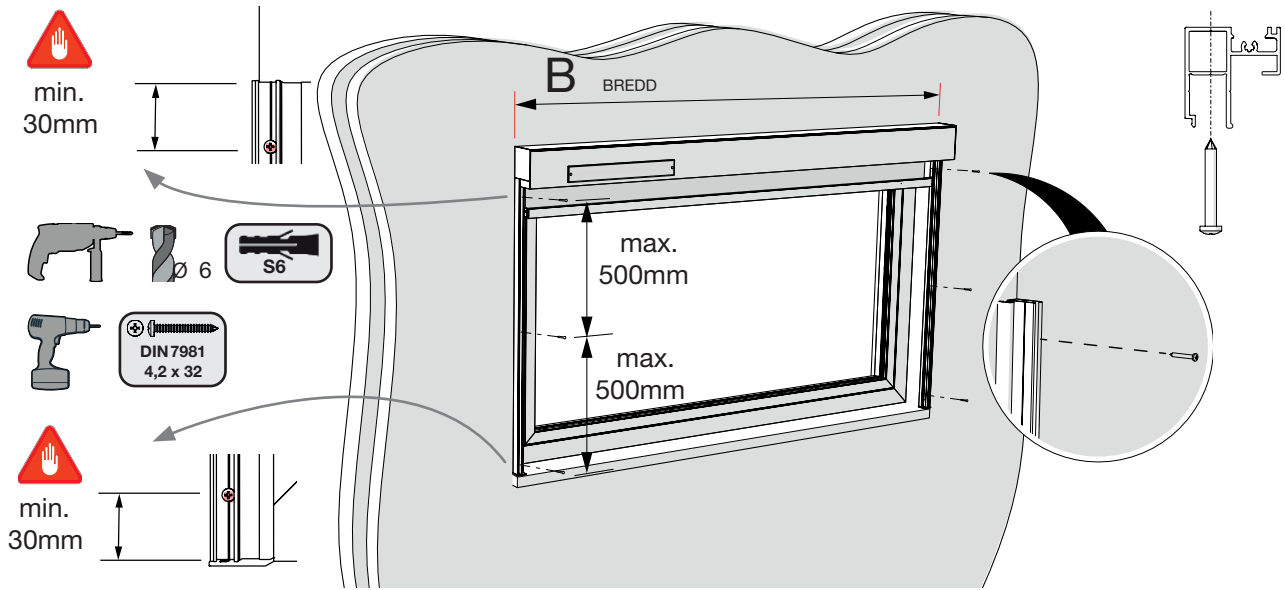

OBS! KONTROLLERA

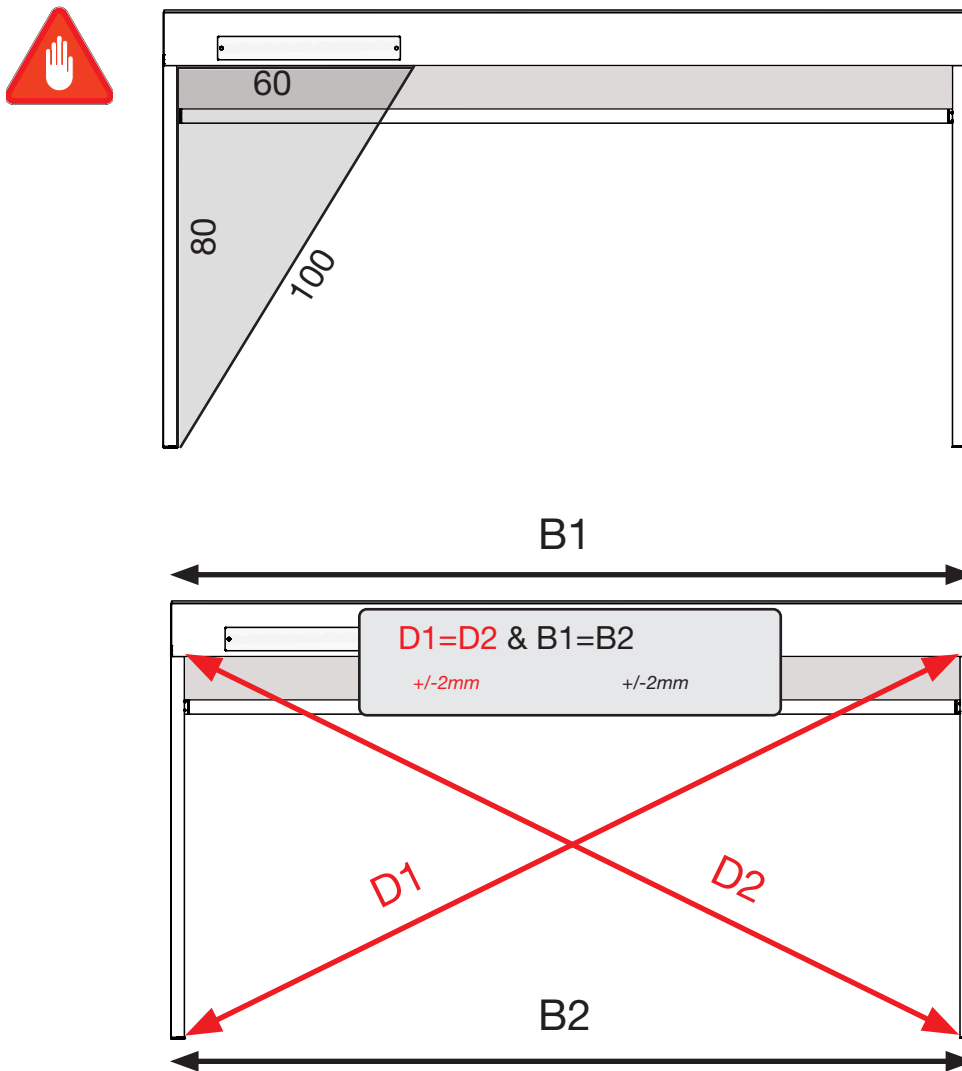

4

MOTOR LED SOLCELL ☀️

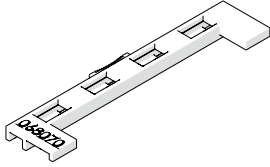
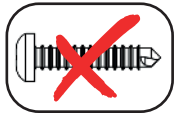

SV LÅS UPP HÖGER OCH VÄNSTER SIDA

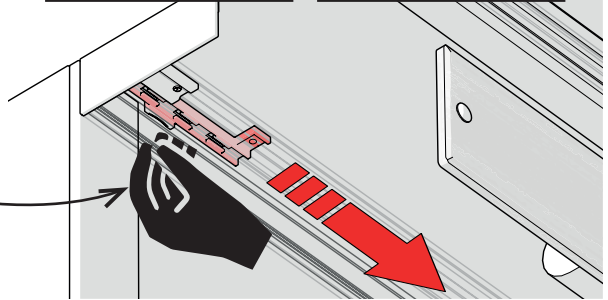
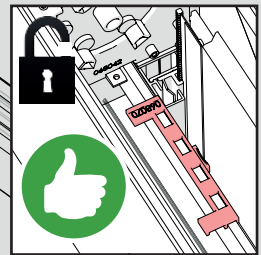
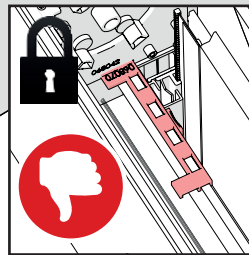
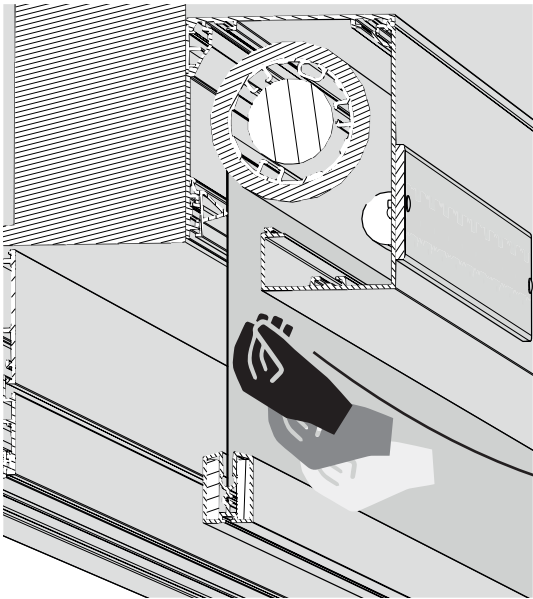
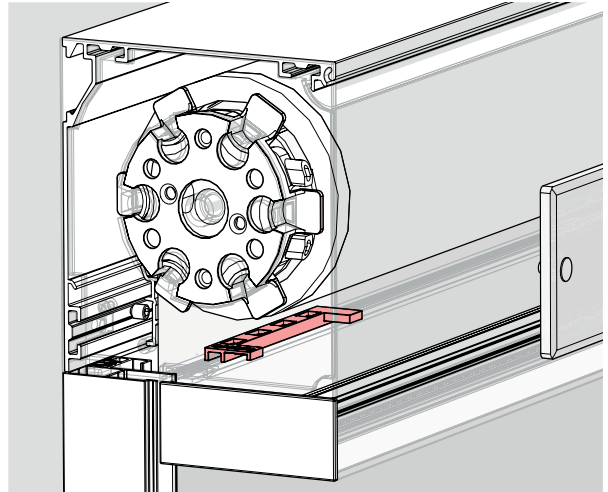

4b

LED SOLCELL ☀️

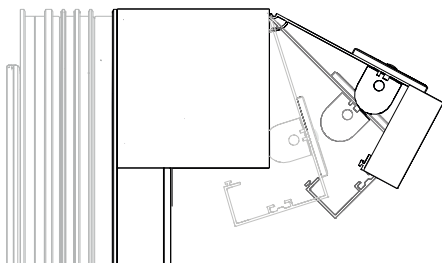

ÖPPNA LOCKET

4c

LED SOLCELL ☀️

LED SOLCELL ☀️

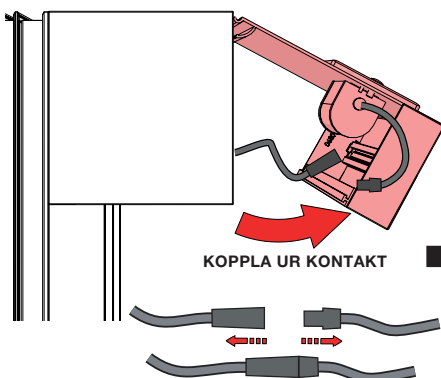

KOPPLA UR KONTAKT

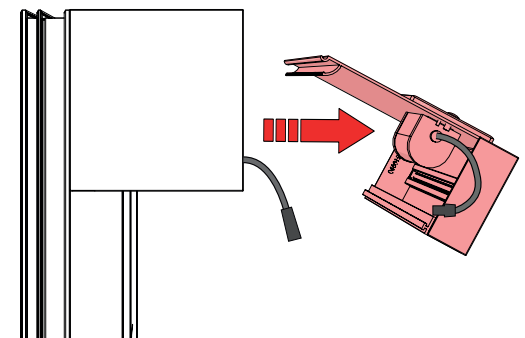

5

MOTOR LED SOLCELL 

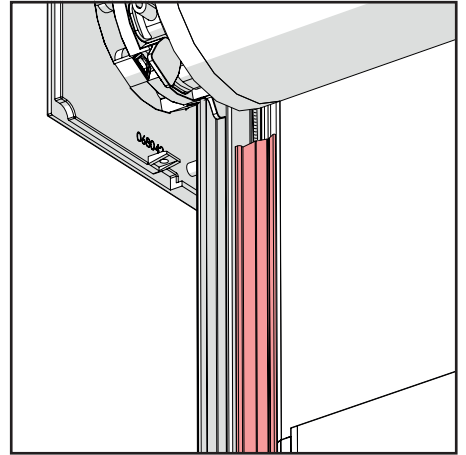
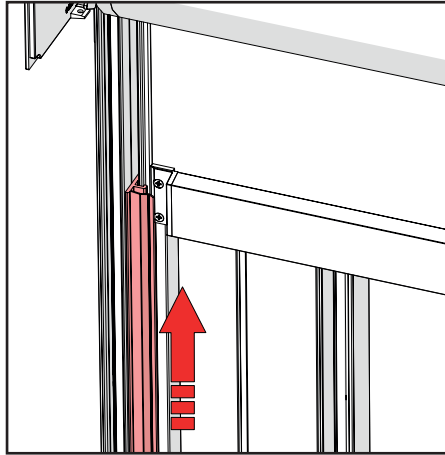
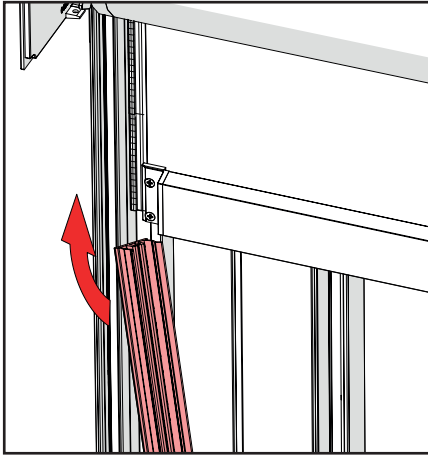
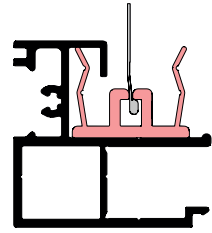
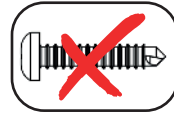
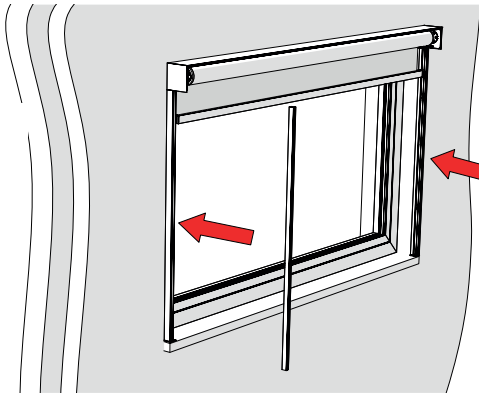

6

SV MONTERING AV GEIDER

MOTOR LED SOLCELL 

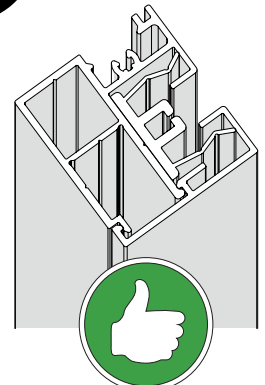
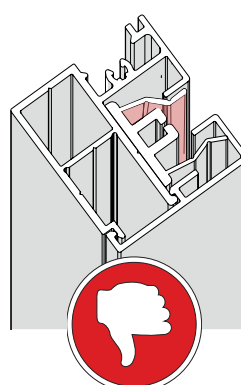
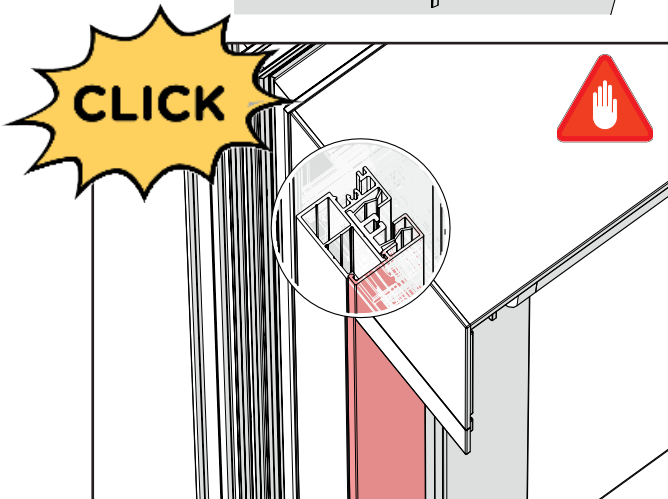
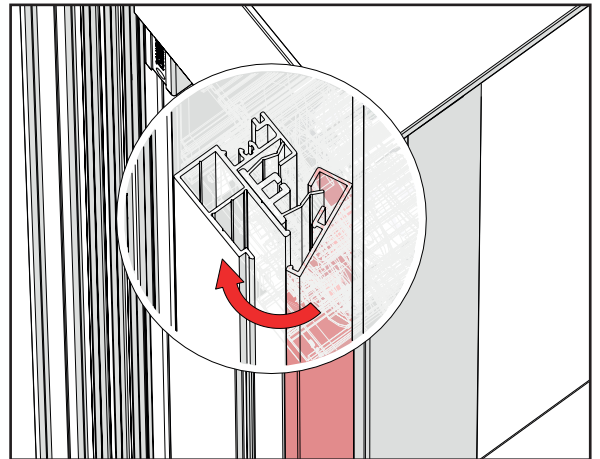
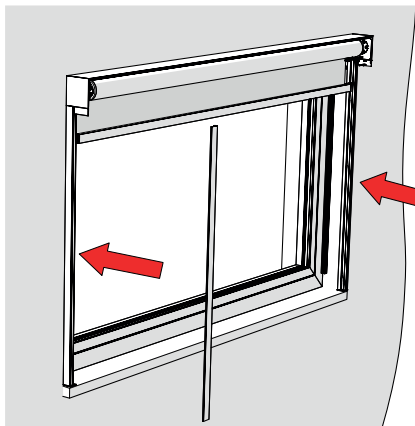

7

LED SOLCELL

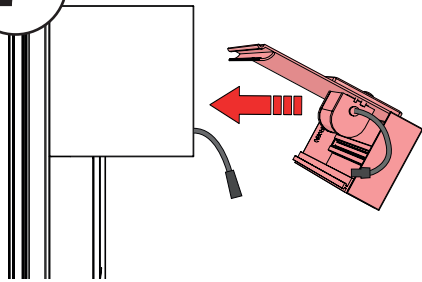

LED SOLCELL

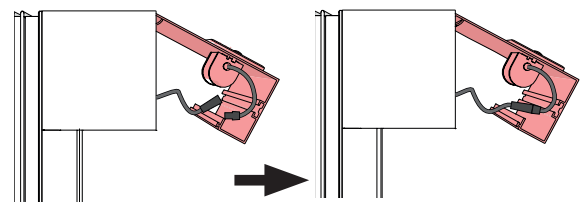

KOPPLA IHOP

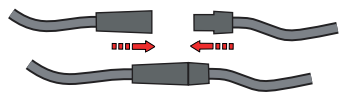

7b

LED SOLCELL



SV LÅS HÖGER OCH VÄNSTER

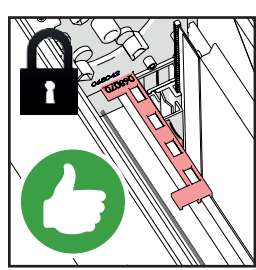
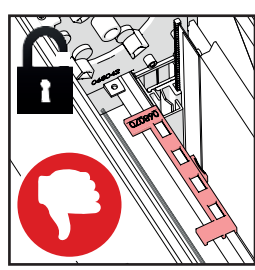
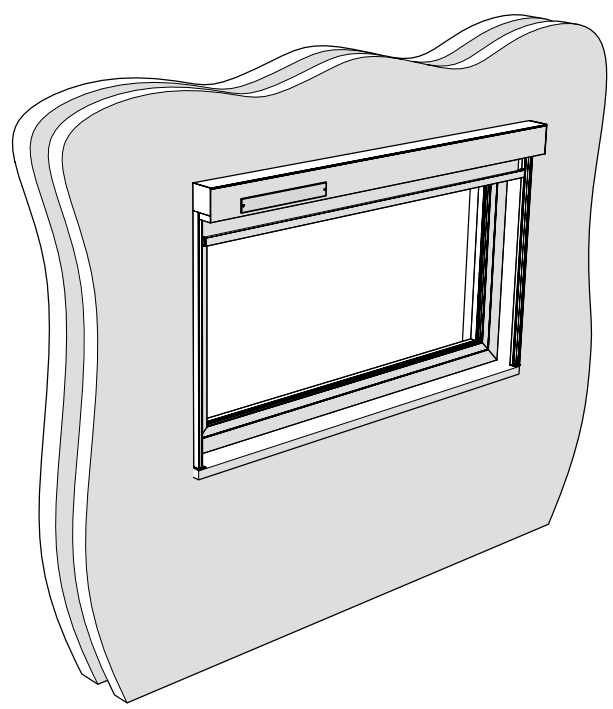
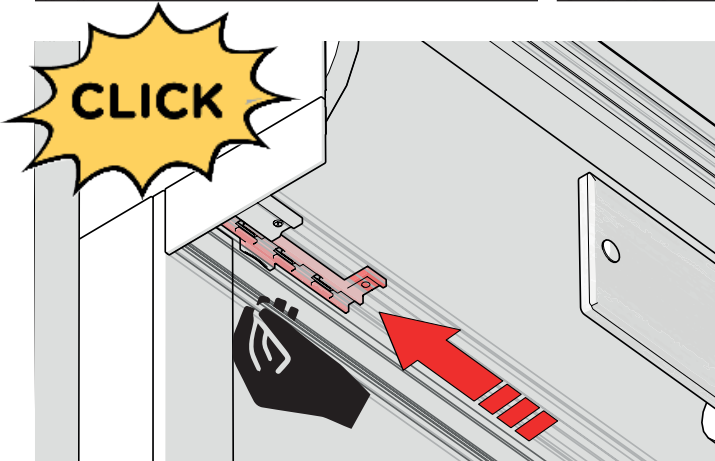
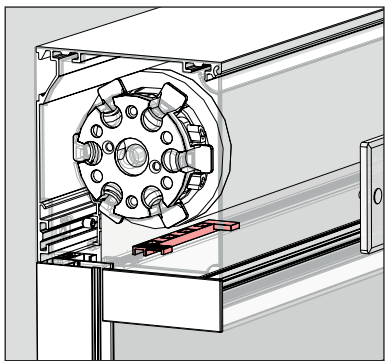
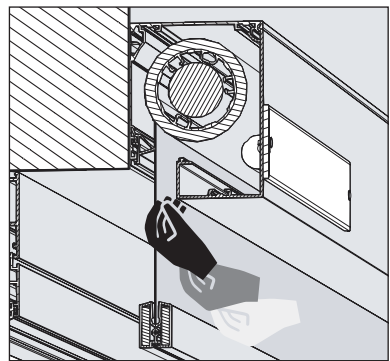
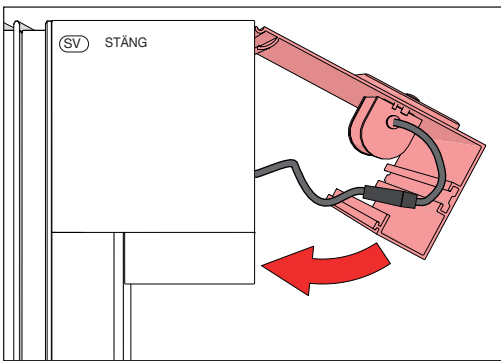
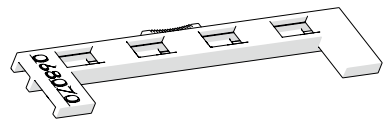

8

MOTOR

LED

SOLCELL 



www.somfy.com



HELP ME



SV FABRIKSINSTÄLLNING

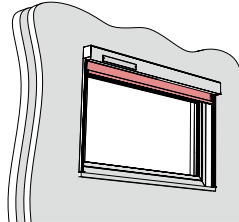

SV NEDRE GRÄNSLÄGET

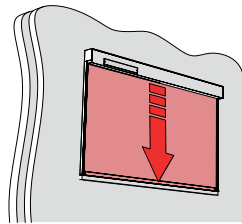

SV ÖVRE GRÄNSLÄGET

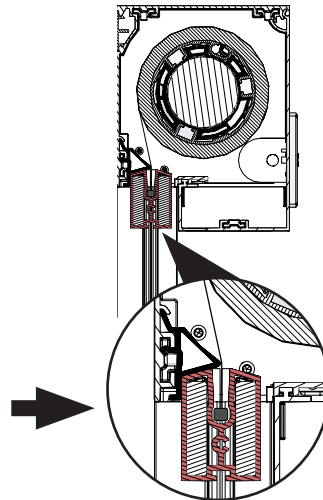
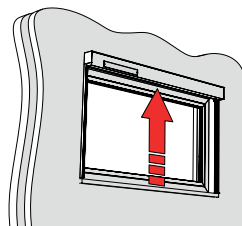

NISCHMONTERING

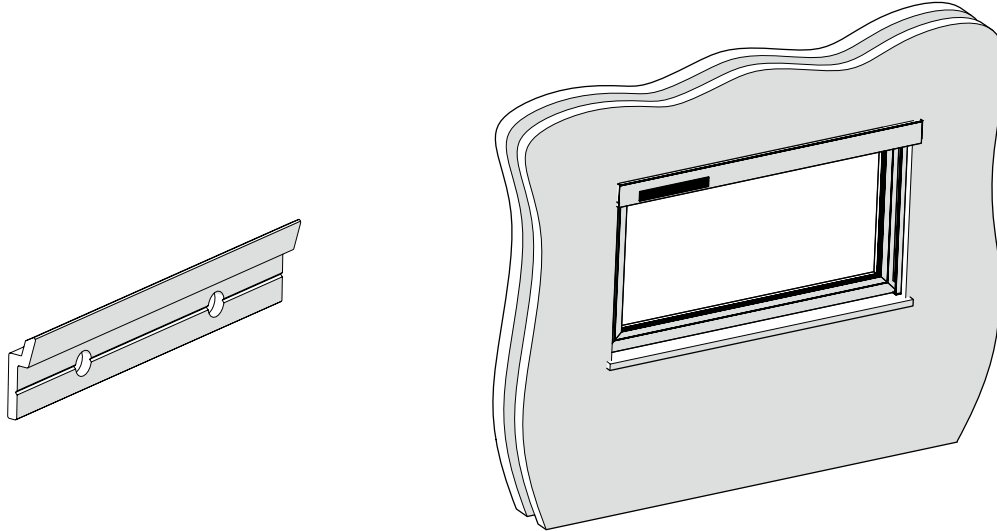

OBS! utrymme som behövs för att öppna kassetten (mm).



OBS! Vid användning av väggkonsol, glöm ej att räkna med extra 10 mm (A) på höjden för att kunna haka i kassetlocket (B)

MOTOR	<p>kassett 90 3 167</p>	<p>kassett 110 4 204</p>	<p>kassett 135 13 251</p>
LED	<p>kassett 90 11 191</p>	<p>kassett 110 19 229</p>	<p>kassett 135 28 275</p>
SOLCELL	<p>kassett 90 11 191</p>	<p>kassett 110 19 229</p>	<p>kassett 135 28 275</p>

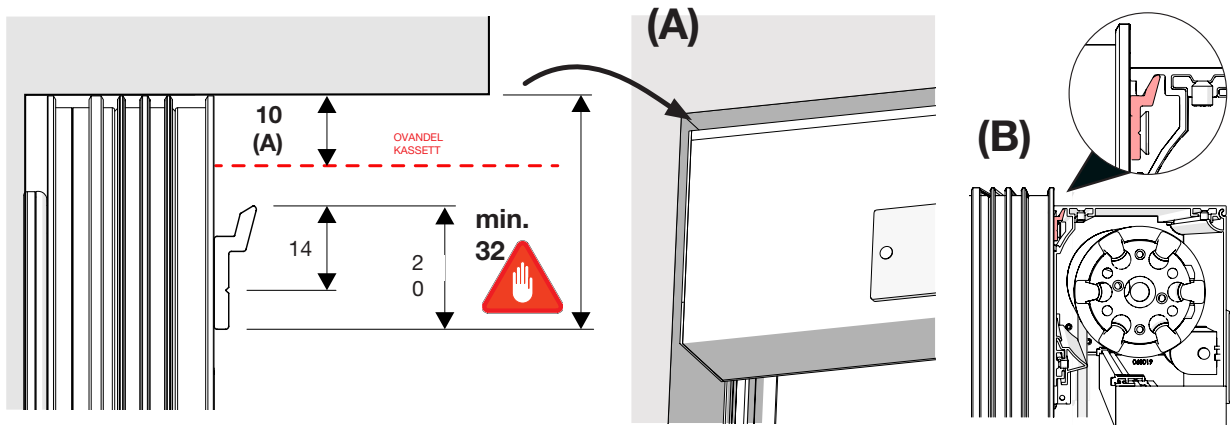

1

MOTOR

LED

SOLCELL 



 **DIN 7982**
5,5 x 50

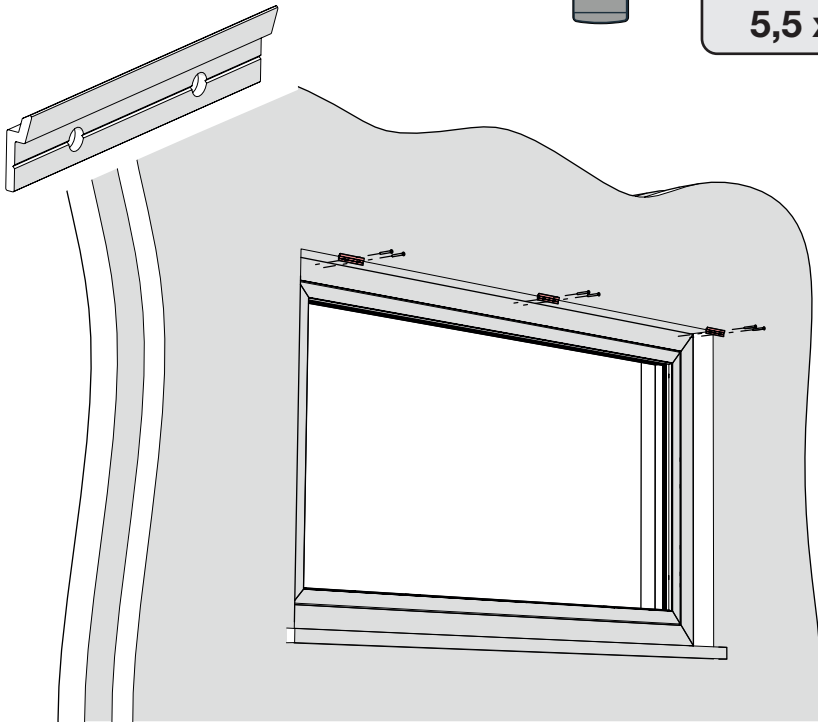
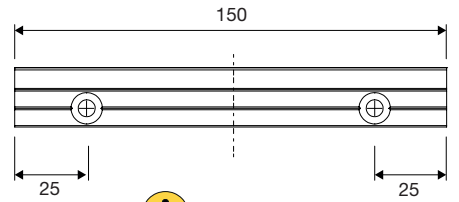

 ÖVERDEL KASSETT

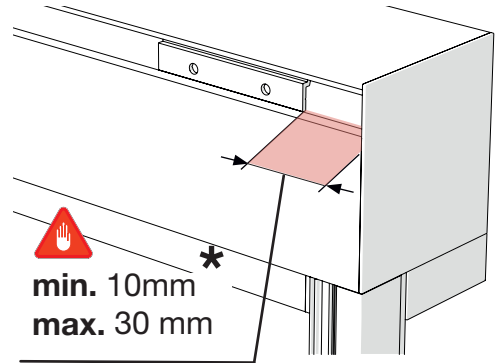
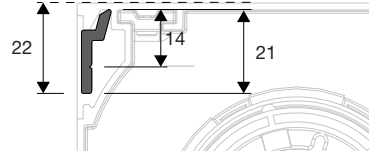

= **B** BREDD
= **B**(BREDD) - 2x(10~30mm)*

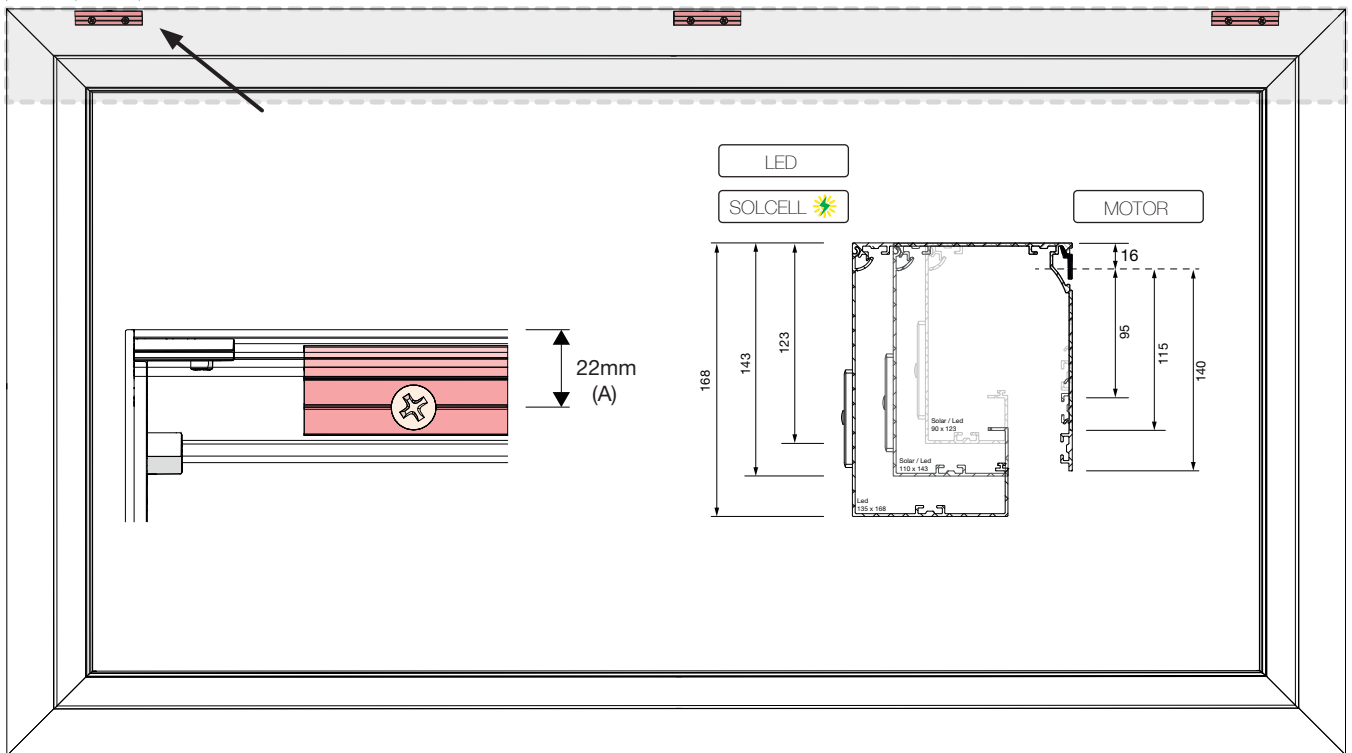
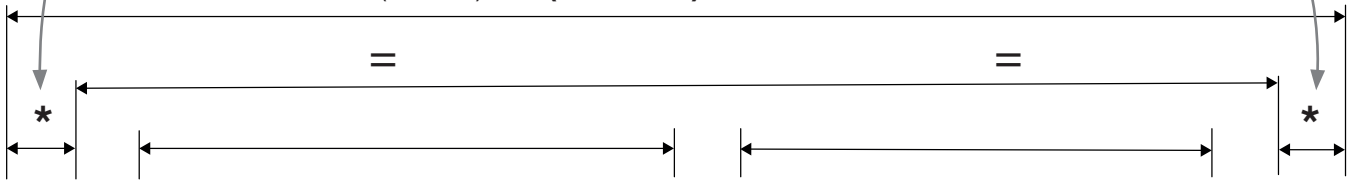

2

MOTOR

LED

SOLCELL 

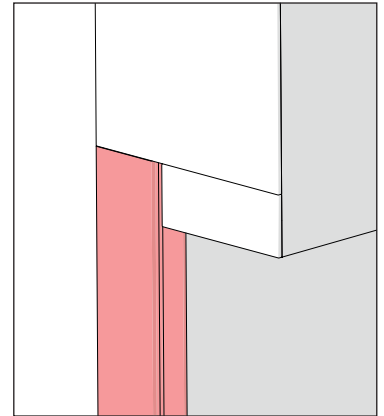
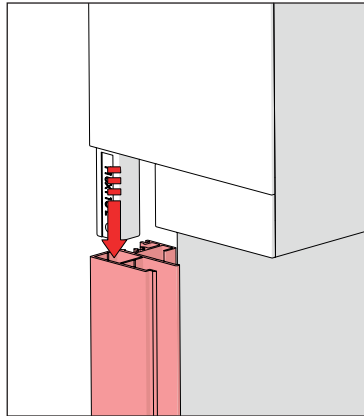
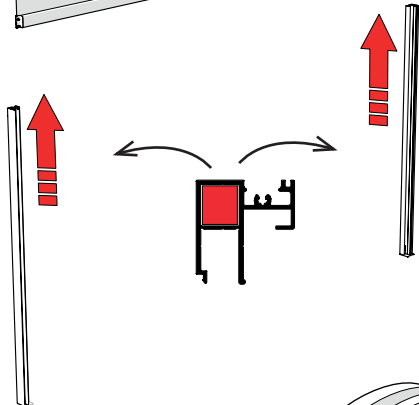
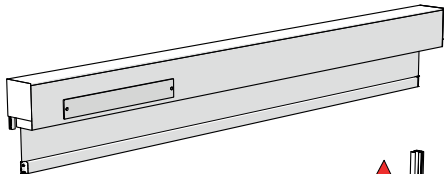
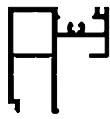
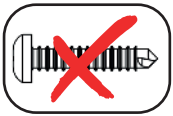

Observera! Var försiktig så att du inte bryter av tapparna genom att flytta styrskenorna för mycket framåt, bakåt eller i sidled!

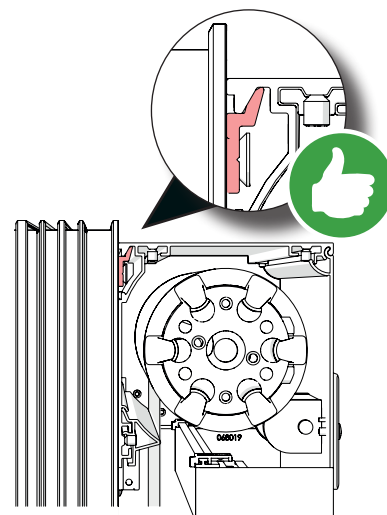
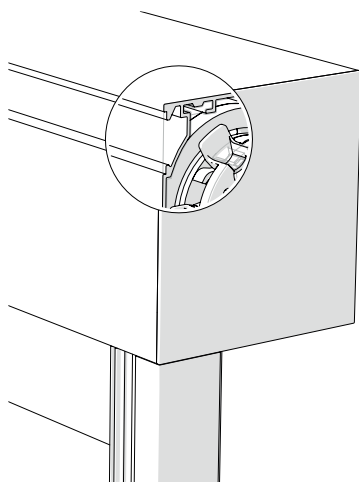
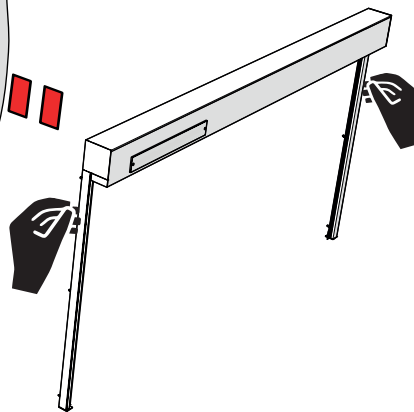
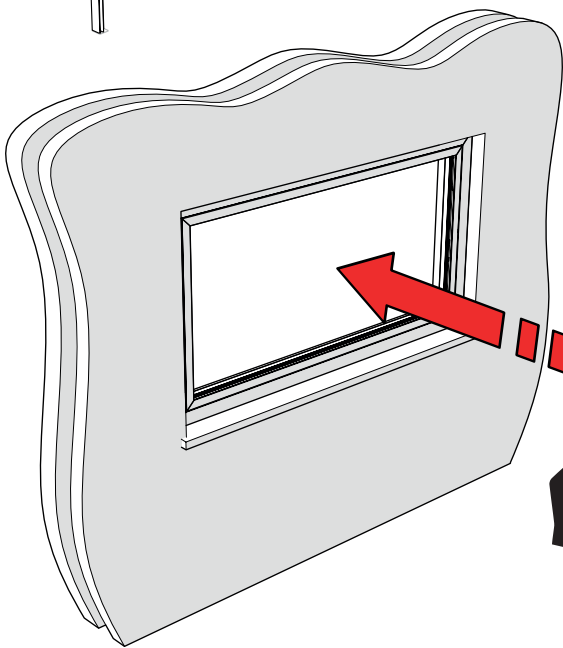

3

MOTOR

LED

SOLCELL 

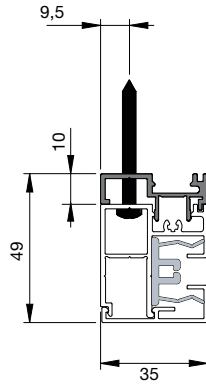
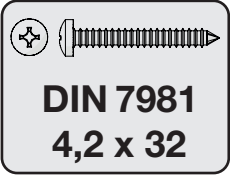
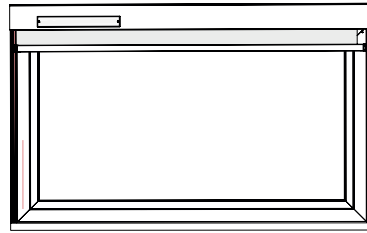
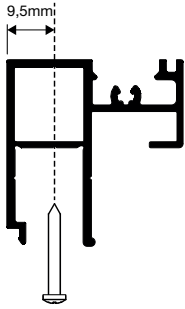

INKL. FYLLNADSPROFIL



OBS!
Olika längder på
skruvarna behövs.

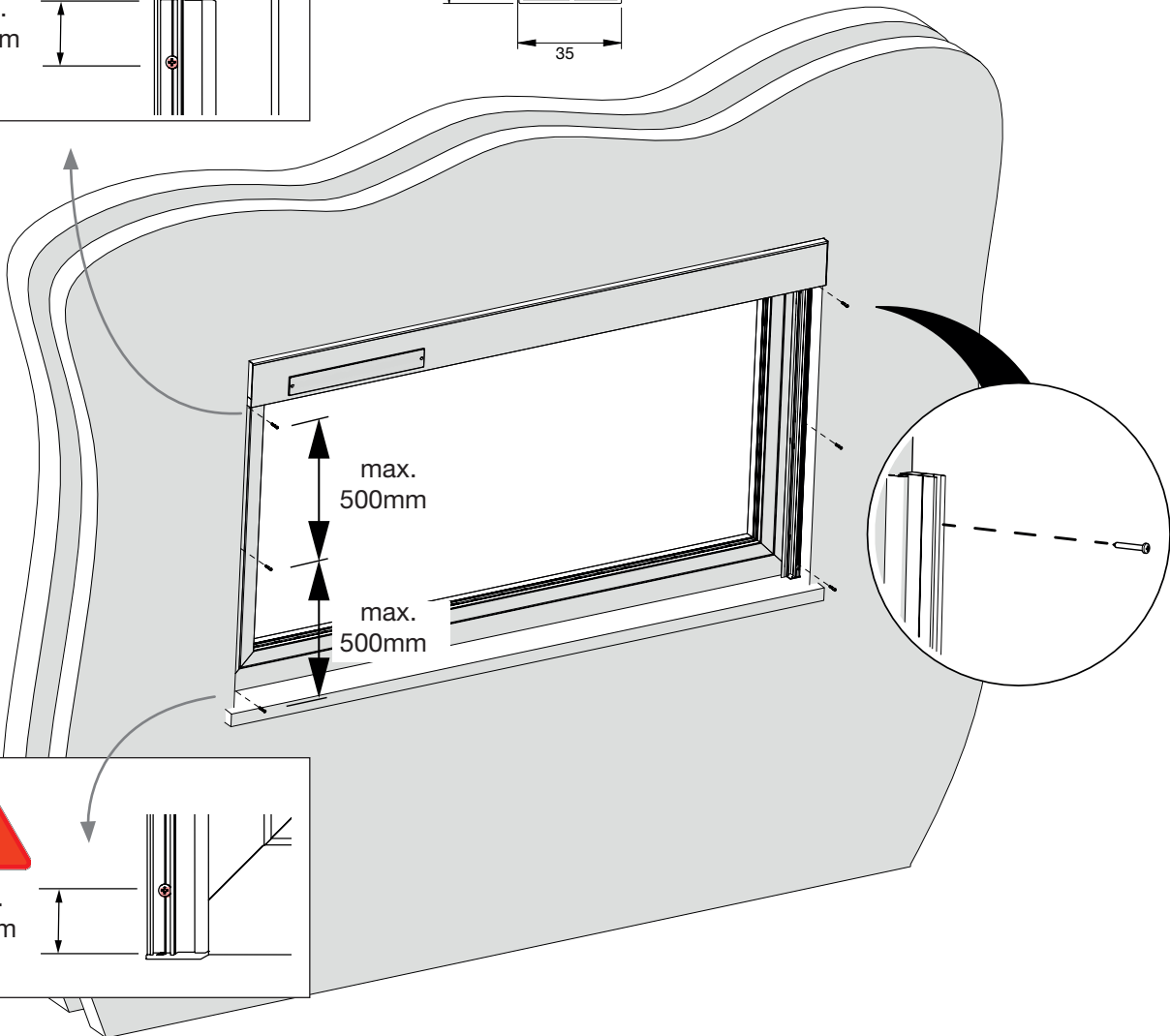
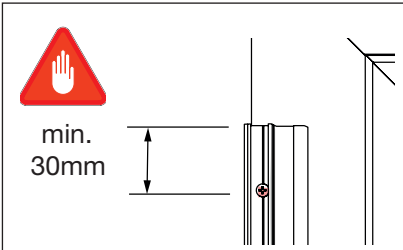

4

5

.....

Se s. 13-16

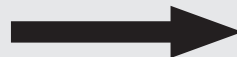

8

ELEKTRISKA SCHEMA

LED
IO
DIMBAR

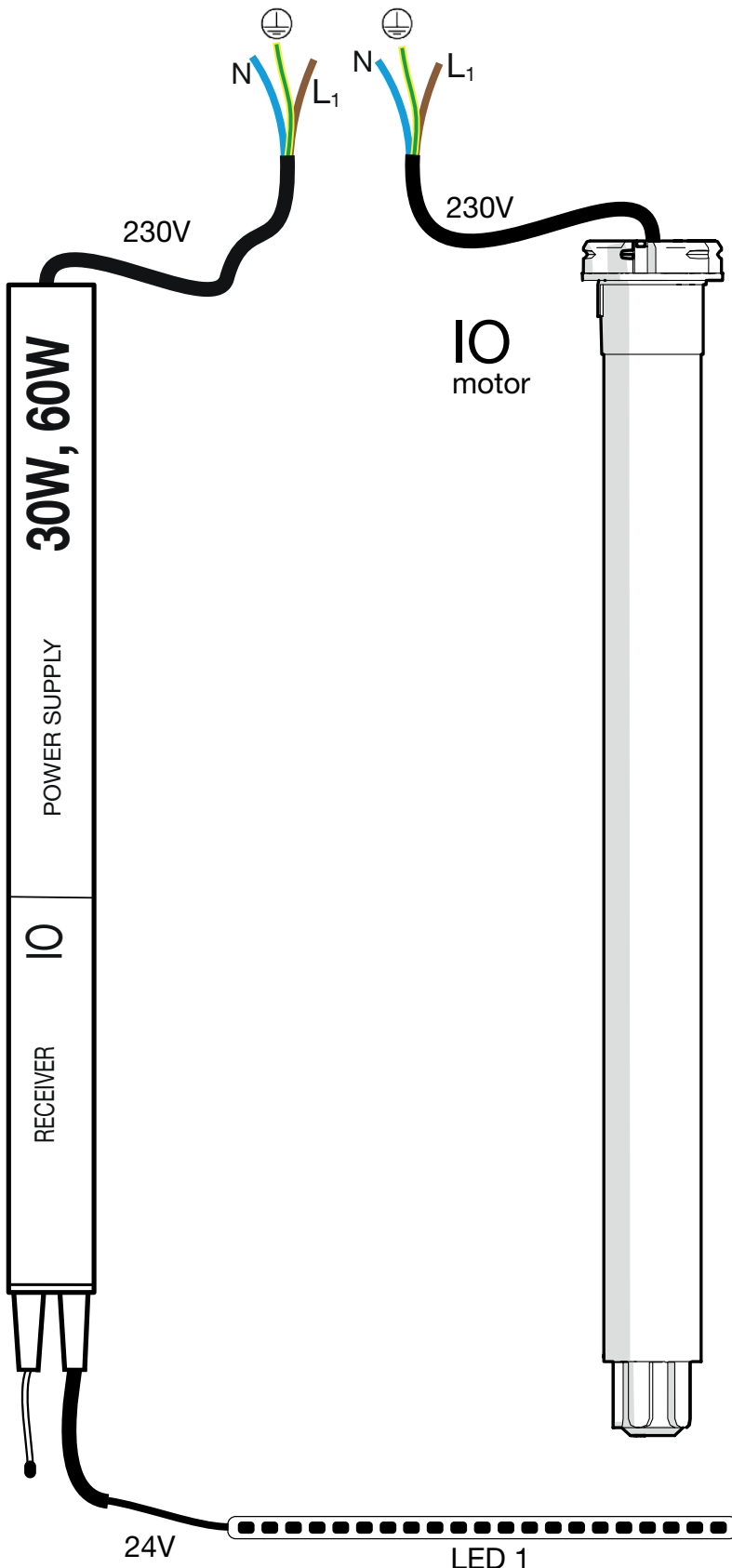

LED STANDARD

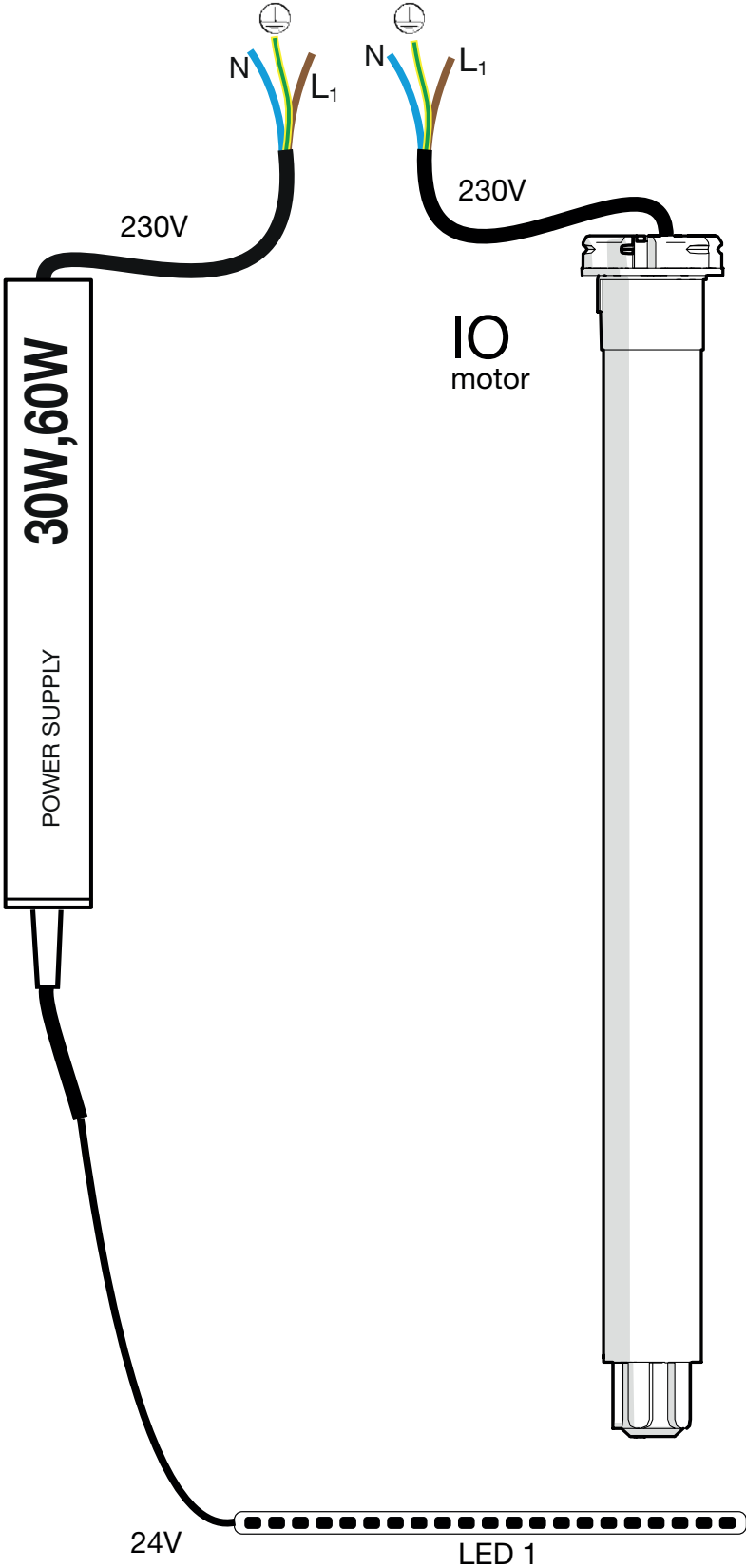

Felsökning – SENSUS

Dina Räckesbutiken-markiser kontrolleras till 100 % innan de lämnar fabriken. Det är därför högst osannolikt att det uppstår fel, till exempel att motorn inte fungerar efter montering. Innan du kontaktar vår service är det lämpligt att först kontrollera följande punkter – de ger förmodligen redan lösningen:

Motorn kör inte in eller ut:

- Kontrollera om motorn har termiskt skydd. I så fall räcker det att vänta i 15 minuter tills motorn svalnat.
- Kontrollera i båda riktningarna att motorn inte nått sin slutposition.
- Kontrollera att kabeln mellan motorn och strömbrytaren inte är skadad.
- Testa motorn direkt med en styrkabel.
- Kontrollera om det finns ström fram (230V) till strömbrytaren med en voltmeter eller testlampa.

Duken har för lite spänning, underlisten fastnar eller blockerar:

- Kontrollera att styrskenorna är korrekt justerade. Underlisten kan fastna mellan profilerna.
- Kontrollera att dragkedjan ligger i dragkedjeprofilen.
- Kontrollera att underlisten hänger i duken och inte vilar på exempelvis fönsterbrädan.
- Kontrollera att duken ligger rätt i styrprofilen.
- Kontrollera att duken inte är för bred.
- Kontrollera att motorns nedre slutläge inte är felaktigt inställt.

Veck eller vågor i duken:

- Kassett och/eller styrskenor är inte i våg. Rikta in dem korrekt med vattenpass (se sidan 11).

Motorn stannar för tidigt eller för sent:

- Ställ in motorns gränslägen på rätt sätt enligt anvisningarna.

Underlisten går ur styrskenorna:

- Kontrollera att ändstopp sitter monterade längst ner i styrskenorna.

Motorn brummar:

- Kontrollera att inget är blockerat och att allt kan röra sig fritt uppåt och nedåt.
- Motorns kondensator kan vara defekt (p.g.a. felaktig inkoppling).
- Motorn kan vara felkopplad: kontrollera anslutningarna. En fas (brun eller svart) kan ha bytts med neutralledaren (blå). Då fungerar motorn bara i en riktning och brummar i den andra.

Motorns rotationsriktning stämmer inte med pilarna på strömbrytaren:

- ↔ Byt plats på den bruna och den svarta ledningen i strömbrytaren.

Underlisten står snett upptill:

- Styrskenorerna är parallella men inte vinkelräta mot kassetten. Kontrollera först att kassetten är i våg, mät därefter diagonalerna och justera monteringen.

Motorn stannar inte i tid:

- Gränslägesbrytarna är inte korrekt inställda.